

The background is a dark teal color. It features several large, semi-transparent circles of varying sizes. Overlaid on these circles and the background are numerous thin, light teal diagonal lines that create a sense of movement and depth.

Optics
Shinland
Each Ray is brighter in Shinland

SL-PL-AO-072A

Details

Material:	PC
Process:	Injection
Diameter:	72mm
Heigh:	32mm
Matched Holder:	Shinland's series AD holders
Matched Cover:	None
ROHS Compliant:	YES
Status:	Ready

Optical Properties

Code	Typ. Angle	Typ. efficiency
SL-PL-AO-072A-S	14°~19°	86%
SL-PL-AO-072A-M	21°~26°	86%
SL-PL-AO-072A-F	37°~39°	89%

Photo



Matched LED type

CLU028

CLU038

CXA15

CXB15

CXA18

CXM-9

Dimensional Figure

Measure Unit : mm

SL-PL-AO-072A-S

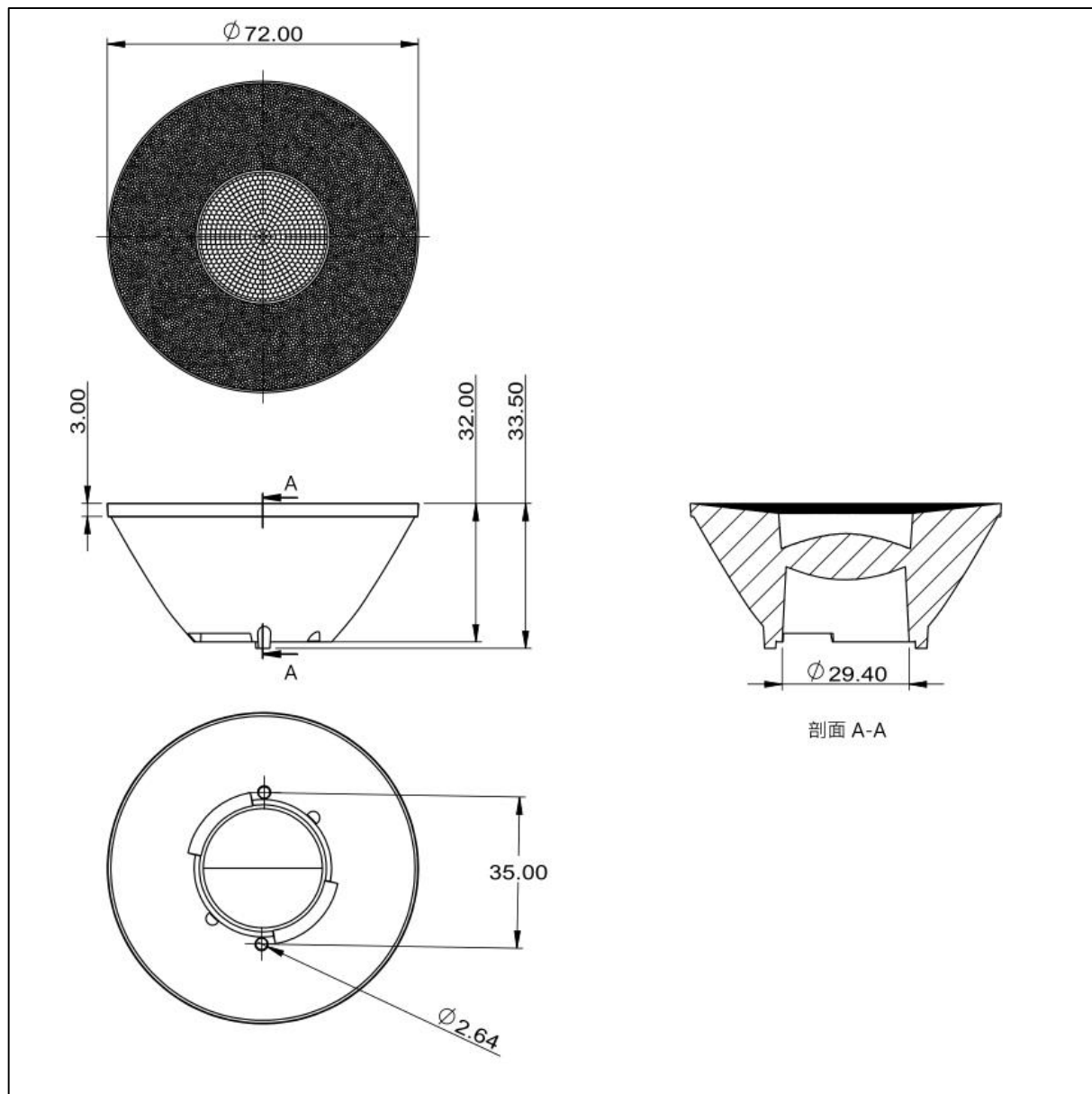

SL-PL-AO-072A-M

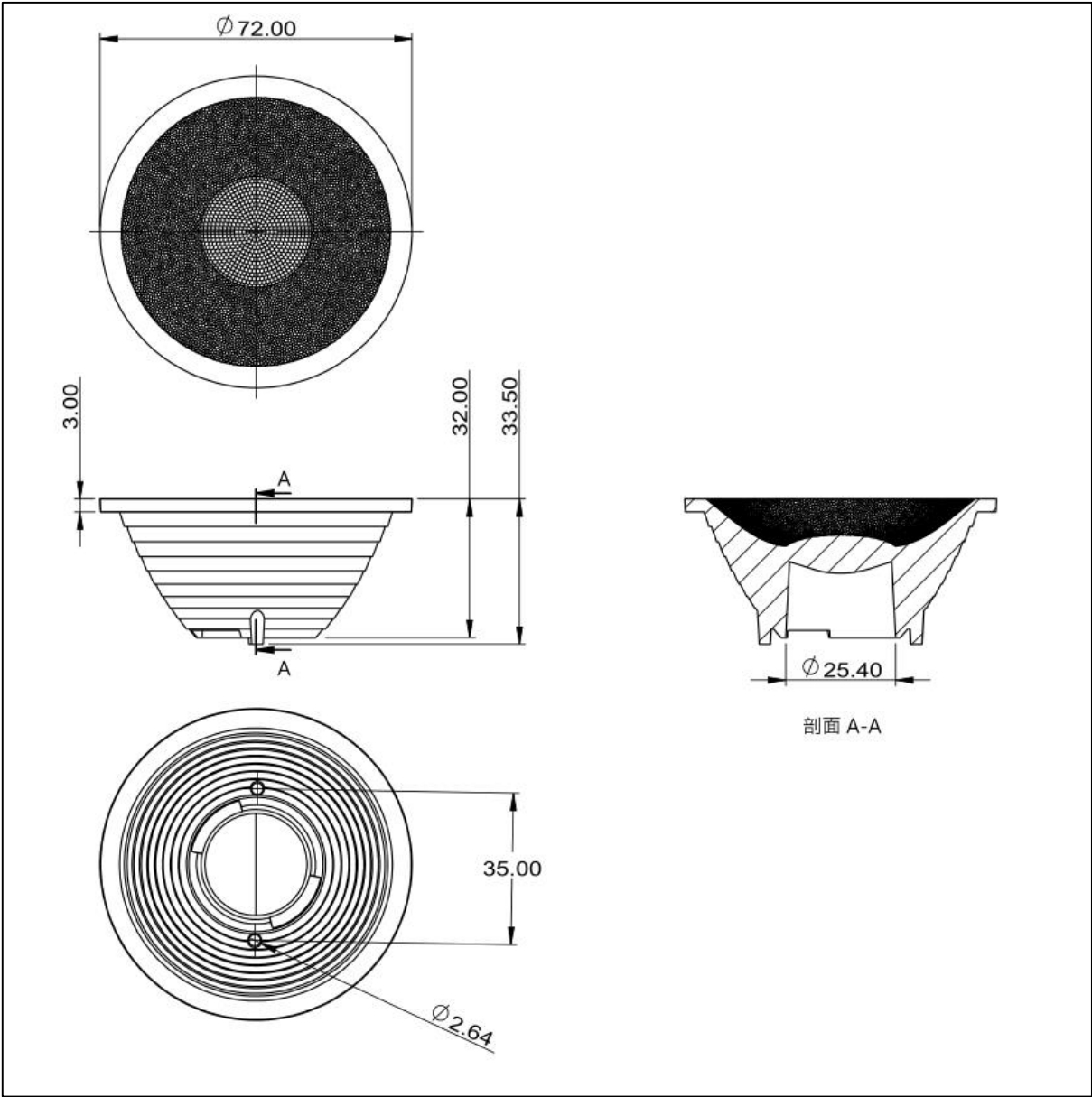

SL-PL-AO-072A-F

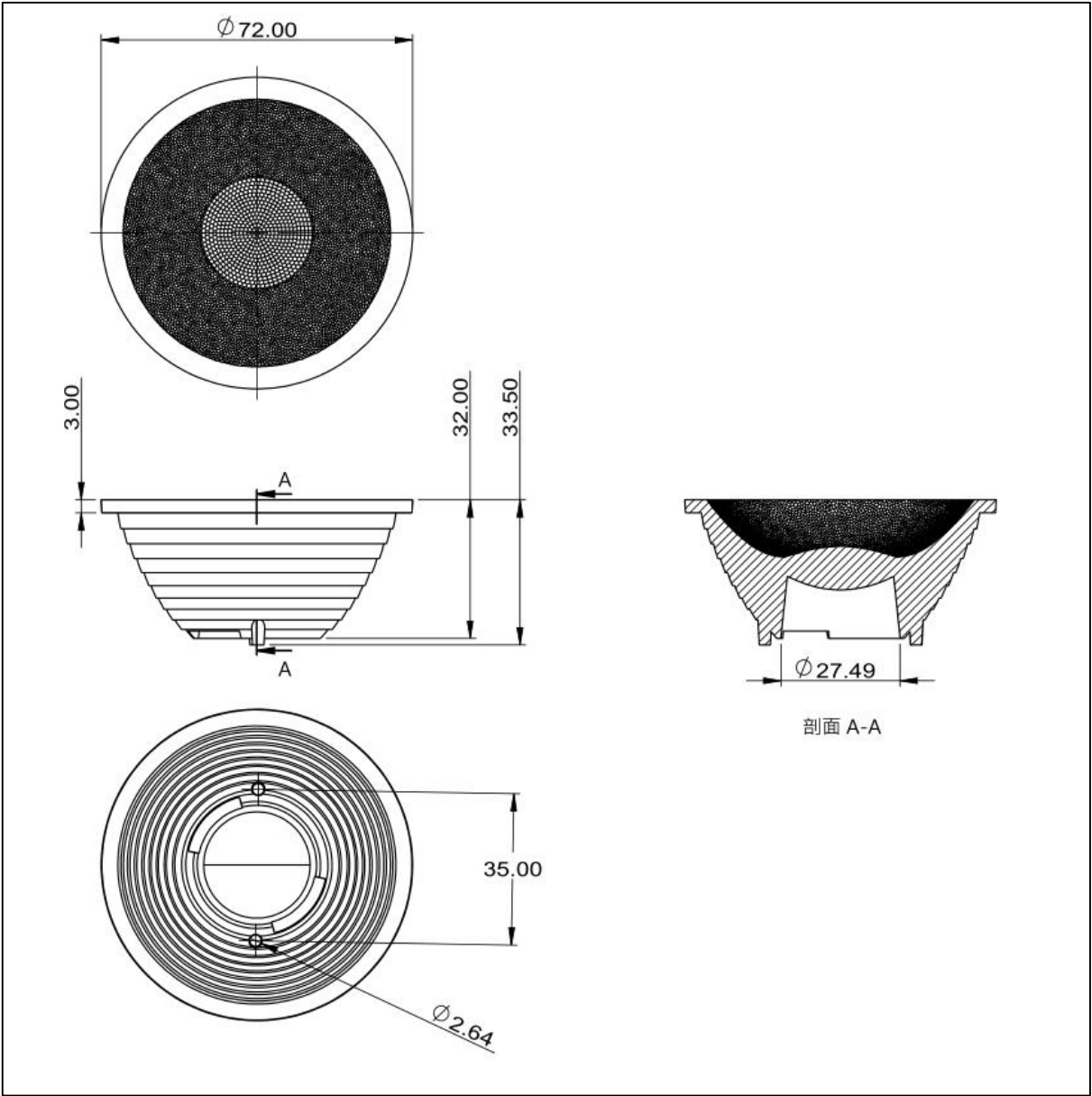

Distribution Curve Flux

Source: Citizen Clu028

SL-PL-AO-072A-S

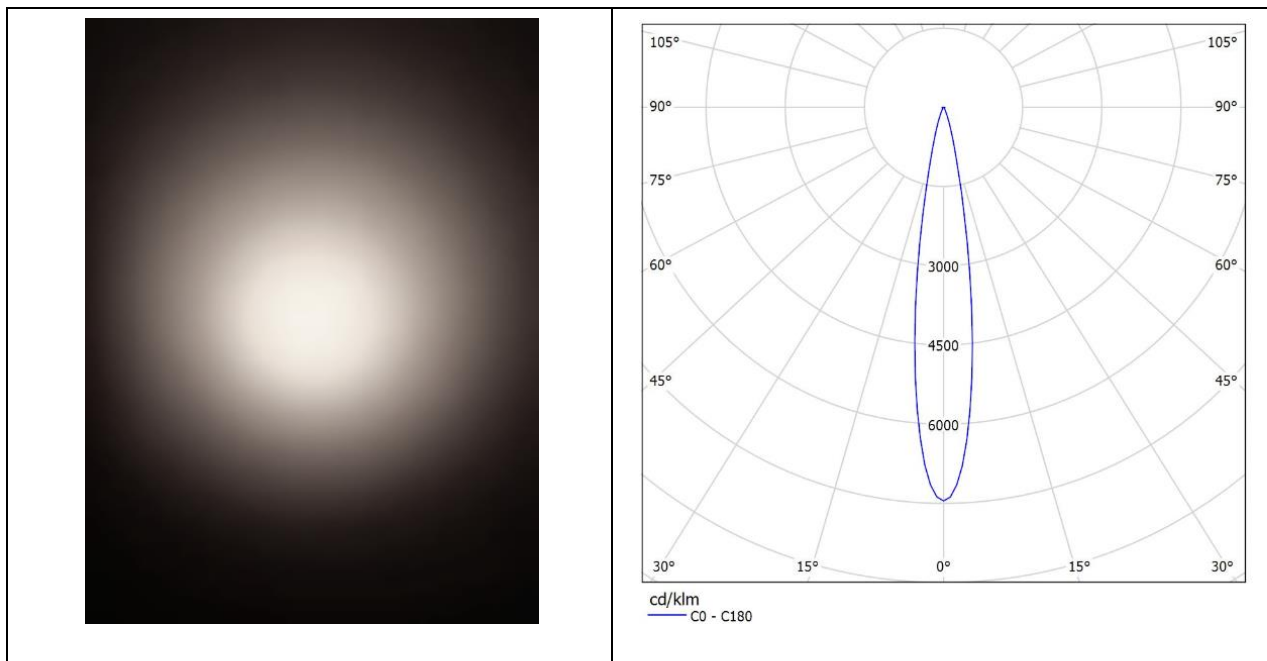

SL-PL-AO-072A-M

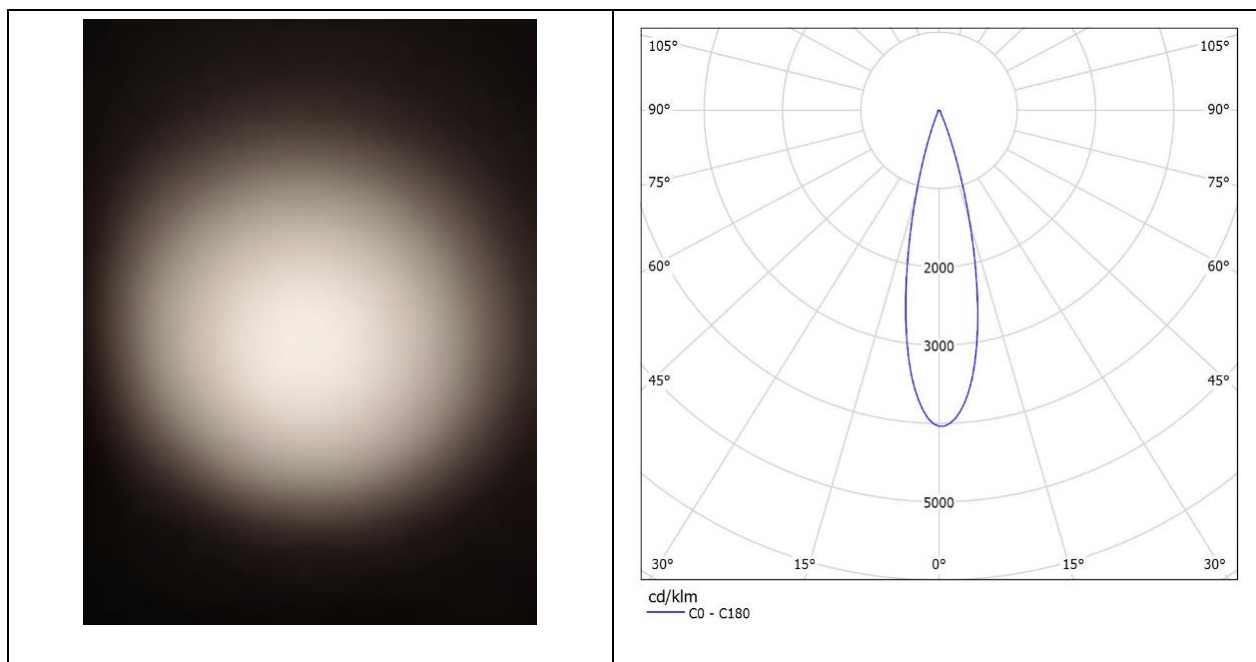

SL-PL-AO-072A-F

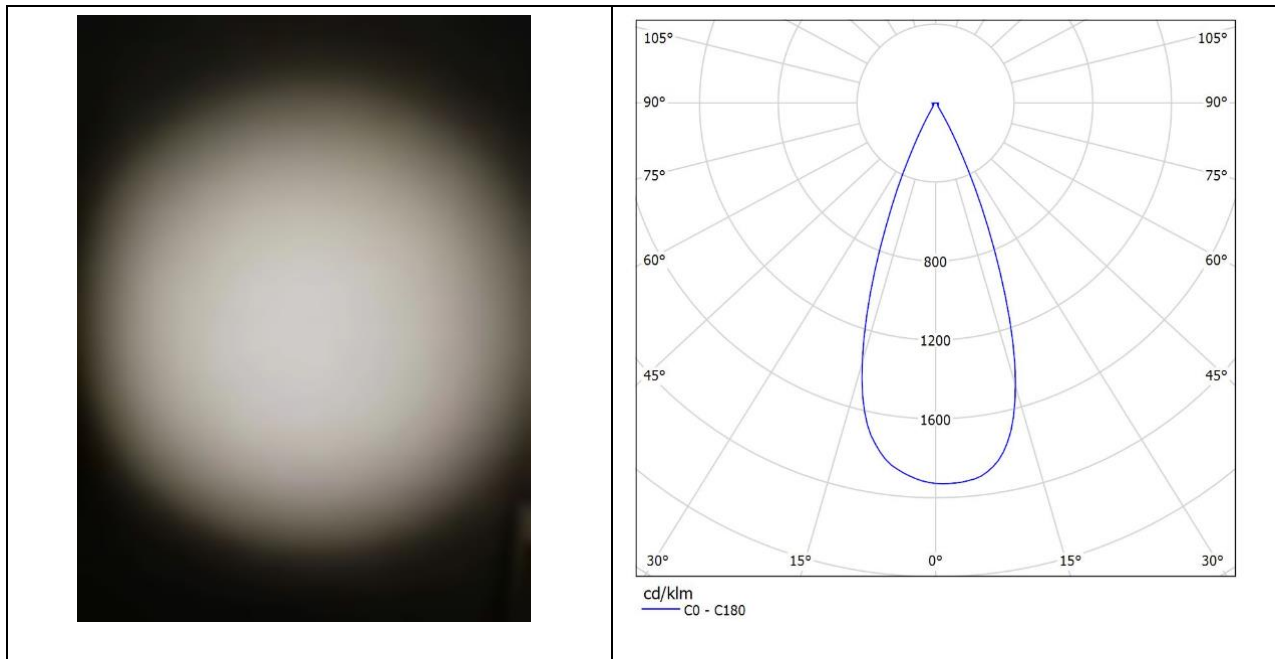

Notes

- It is not allowed to scrub the reflective surface. If there is dust on the surface, please clean by soft cotton with little water.
- It is forbidden to clean with industrial solvent such as ethanol.
- Storage temperature: 0°C-40°C, and humidity:30%-95%.
- Keep reflector in package to void the dust.
- Prohibit the reflector touch with acid or alkaline solvent.

About Shinland

Shenzhen Shinland Co. Ltd, one of the longest and most professional company in reflector field, have years experience. Different from other factory which only have simple process, all aspects included R&D, making mold, mass production and

market support are achieved by our exclusive resources.

Insisting on “Quality First, Service First” and pragmatic, enterprising spirit, building the market by quality, casting our brand by credibility and integrity, Shinland now become the leading supplier of second-optical solution in China.